

ADA Accessible Resources

- All public entrances and elevators are accessible.
- Accessible public parking is available in all garages.
- Complimentary valet is available in front of the West, East and North Medical Buildings. Wheelchairs are available for patients and visitors using valet services.
- To access interpreter services Monday through Friday, 8 a.m. to 4 p.m., call 314-205-6901. For afterhours and weekends, call 314-205-6971.
- ADA equipped and accessible rooms are available throughout the hospital. Please call 314-205-6971 to request one.
- Complimentary wheelchairs are available at the main entrance and the fountain area of the North/South medical building.
- Accessible restrooms on floors 1, 2 and 3 are marked on the map. Additional accessible restrooms throughout the campus are marked with appropriate signs.
- The Lake View Café and Fountain Café are accessible. Staff are willing to assist patients and visitors when needed.

Comments/questions,
please contact
Corporate Compliance.
St. Luke's Hospital
224 S. Woods Mill Road
Chesterfield, MO 63017
314-205-6516
stlukes-stl.com



Our specialty is you.
stlukes-stl.com

1-3297-
Rev 3/2021

Welcome to St. Luke's Hospital

ADA Accessible Resources



Key

-  Women's Restroom
-  Men's Restroom
-  Handicap Accessible Restroom
-  Elevator
-  Information Desk

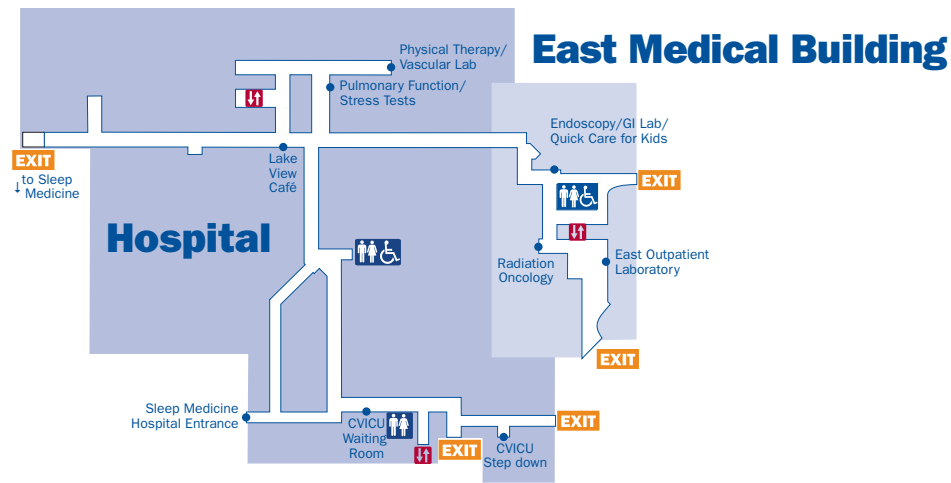

1st Floor

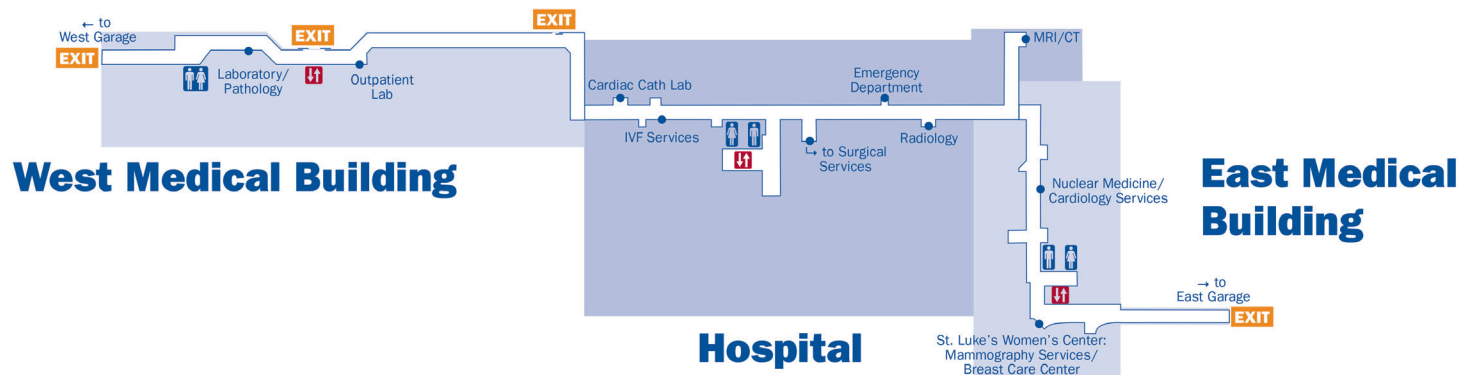

2nd Floor

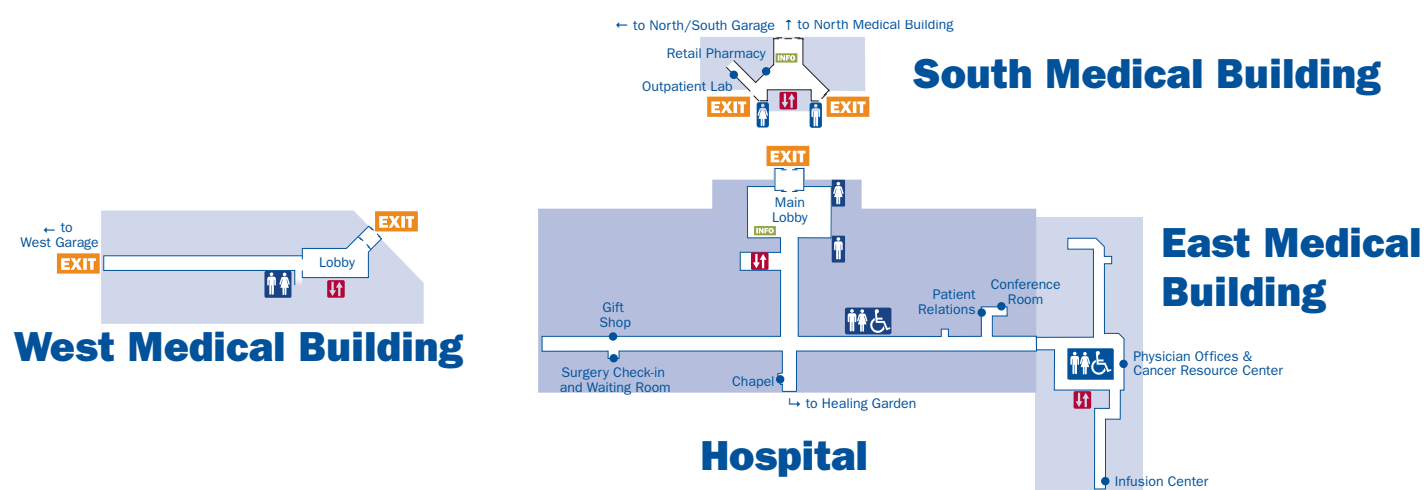

3rd Floor (street level)